

Touch Free Hydrophilic Intermittent Catheter

The photograph shows a white and red striped Hollister VaPro Plus pocket. The top left corner features a circular logo with a 'V' and a '+' sign. The text 'VaPro Plus' and 'pocket' are visible. The Hollister logo is at the bottom. To the right, a diagram illustrates the pocket's use: a blue tube with a red handle is inserted into the pocket, which is shown as a blue bag with a white band and a green tab. The diagram is set against a grey background with a circular cutout.

- ## Notes

 **Hollister**



Guide for Use



Touch Free Hydrophilic Intermittent Catheter

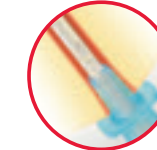

- Catheter located outside the collection bag for convenient handling



Continence Care
People First



VaPro Plus
Touch Free Hydrophilic Intermittent Catheter

How the Urinary System Works

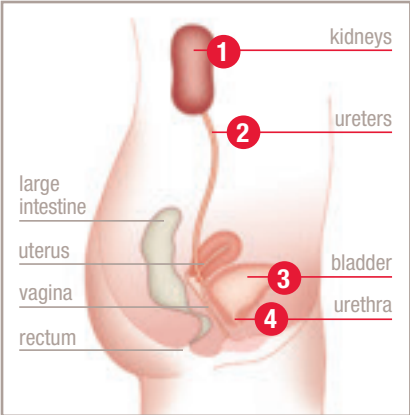
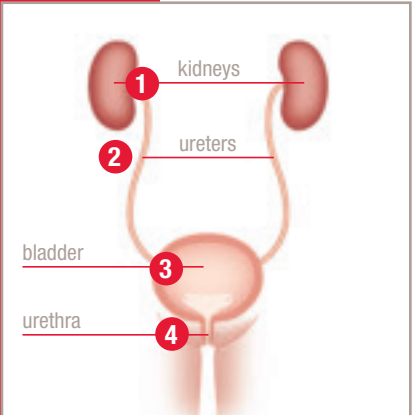

- 1 Urine is produced by the kidneys, which filter out the waste products of your body.
- 2 The liquid waste is passed via tubes called ureters to your bladder, the organ that stores urine.
- 3 When the bladder becomes full, a signal is sent to the brain to tell the urethral sphincter muscle to relax and the bladder to contract.
- 4 Urine flows down the urethra, the natural tube through which urine exits the bladder, and out of the body.

Self-Intermittent Catheterization (SIC)

When the bladder does not empty on its own, SIC may be recommended. SIC should be carried out under medical advice and only in accordance with product instructions. It involves using a catheter to drain urine from your bladder via the urethra. Urine should be expelled on a regular basis throughout the day to keep the body healthy.



Wash hands with mild soap and water.



To open the catheter package, pull top finger hole toward you at least halfway down the package.



Remove the catheter from the package.

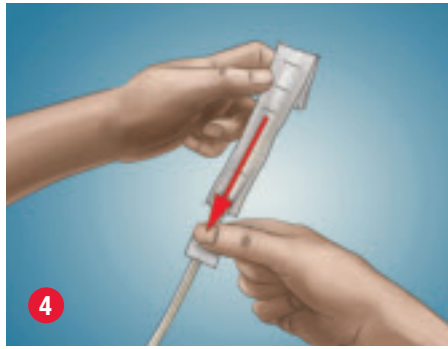

Release collection bag by slipping paper band toward the catheter and off the bag, or place the catheter on a flat surface, and with the bottom of the fist, lift the bag away from the catheter to release the paper band.



Spread the labia and cleanse around the opening of the urethra with mild, unscented soap or a non-alcoholic wet wipe.



Remove the red ring cap from the protective tip of the catheter.



Hold the catheter in one hand, and with the other hand advance the catheter forward until the tip of the catheter fills the protective tip, taking care that the catheter does not protrude from the tip.

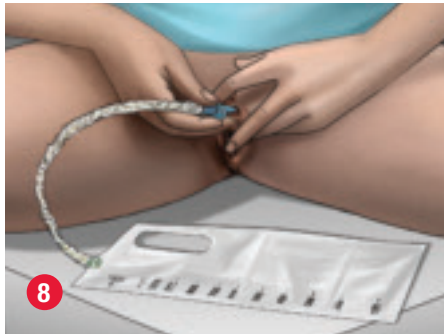

Part the labia with two fingers. Grasp the catheter below the protective tip plate, and insert the protective tip until the base comes in contact with the urethral opening. Release the labia. **Keep the protective tip in place.** Insert the catheter forward until urine starts to flow. Once the urine flow has stopped, slowly withdraw the catheter to ensure the bladder is completely empty. Then gently remove catheter completely.

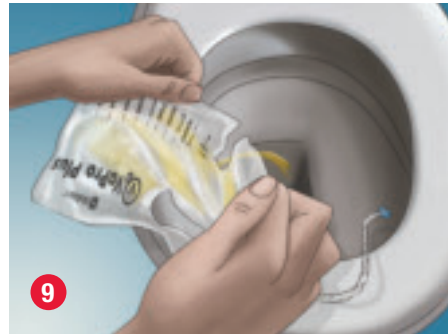

To empty the collection bag before disposing, tear at the arrow (Tear here to empty) to drain urine.



The catheter may be disposed of in a waste bin. Do not flush it down the toilet.



Wash hands with mild soap and water.

Notes
