

Collect Supplies

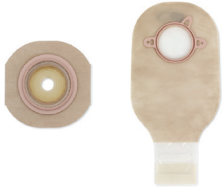

Gather pouch, skin barrier, disposal bag, tissue and/or cloth for cleaning, and water. Optional: accessories.

Prepare the Skin Barrier



1 Remove the release liner from the skin barrier.

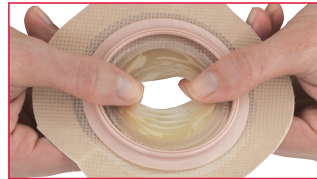

2 Shape the skin barrier to the dimensions closest to the stoma size. Shape by stretching the skin barrier material from the center hole towards the floating flange. Do not roll.



Remove Used Pouching System



3 Press against the skin and peel the skin barrier away from your body, beginning at the top and working downward. Properly dispose of used pouch and skin barrier. Do not flush down toilet.

Clean and Dry Skin



4 Clean the skin with water or with gentle soap as recommended by your healthcare provider. Rinse and dry thoroughly. Do not use oils, powder, lotion, or lotion-type soaps on the skin.

Apply the Skin Barrier

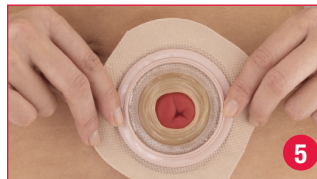

5 Center the skin barrier opening over the stoma in a diamond shape.

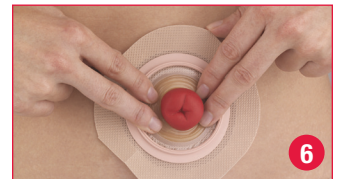

6 Smooth the skin barrier material towards the stoma to ensure no peristomal skin is showing.



7 Remove the tape liners on both sides and press tape against the skin.

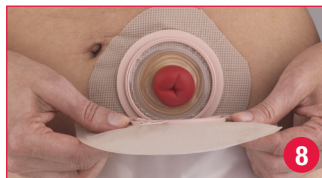

8 Apply pouch to the skin barrier by engaging the lower edges of the pouch flange and the skin barrier flange. Press the two flanges together. A series of "clicks" will confirm you are doing it correctly. No more "clicks" means the pouch is secured.



9 Warm for approximately 30-45 seconds (warmth and gentle pressure help activate the adhesive).



10 Close bottom of pouch. If using a drainable pouch, close the Lock 'n Roll Microseal closure at the bottom of the pouch or apply a pouch clamp. Refer to the Lock 'n Roll Microseal Closure Care Tip for more information on how to use this closure system.

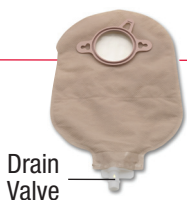

If using a urostomy pouch, make sure the drain valve is closed. The teardrop on the drain valve should face the body side of the pouch. If desired, apply the cap provided in the box.

Tips

- The stoma may be swollen after surgery. It may take up to six weeks for the stoma to stop shrinking.
- The stoma may bleed slightly when you clean it.
- The skin around your stoma should not show any signs of rash or sores. Irritated skin should be evaluated by a healthcare professional.
- Ensure that the barrier is stretched and not rolled.
- Smooth barrier in place snug around stoma and ensure there is no gap or exposed skin.

List of products

	Stock No
New Image Two-Piece Pouching System	
FormaFlex Skin Barrier 1-3/4" (44 mm)	14102
2-1/4" (57 mm)	14103
2-3/4" (70 mm)	14104
Pouch	_____
<i>Accessories</i>	
Adapt Barrier Rings	_____
Adapt Ostomy Belt	_____
Adapt Paste	_____
Adapt Lubricating Deodorant	_____
Adapt Stoma Powder	_____
Other _____	_____

Frequently Asked Questions

Q: Will the skin barrier become less sticky after touching it?

A: The FormaFlex Skin Barrier is designed to be stretched by hand. However, it is important to ensure you that you do not over handle the product, and your hands are clean and free from lotions or powders.

Q: Can the FormaFlex Skin Barrier be cut?

A: The FormaFlex Skin Barrier will still work as expected even if it is cut to the correct size.

Q: What if I over stretch the skin barrier?

A: One of the key benefits to the FormaFlex Skin Barrier that is very flexible. If the skin barrier material is over stretched, simply smooth it back towards the stoma, ensuring no peristomal skin is showing.

Additional Instructions

For product questions, sampling needs, or detailed clinical questions concerning our products in the US call **1.888.740.8999**. In Canada call **1.800.263.7400**.



Hollister Incorporated
Libertyville, IL USA

Distributed by
Hollister Limited
Aurora, Canada
1.800.263.7400

www.hollister.com